

# SONIC LITE

Travel Trailers



2018 Décor



Coffee

Latte

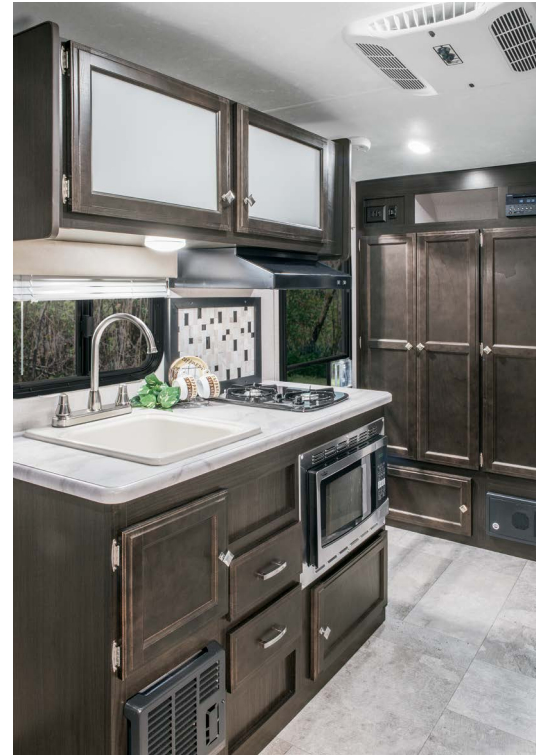

## Living Room/Kitchen

- Seamless Countertop w/Sink Cover
- Roller Ball Bearing Drawer Guides
- Safe "T" EK Box w/USB Charger
- High Efficiency LED Lighting
- (2) Interior Speakers
- 82" Interior Height
- Skylight
- Linoleum w/3 Year Warranty
- Pleated Nightshades
- Shoe Cubby (VBF)
- Mountain Walnut Mortise and Tenon Hardwood Doors

## Bathroom

- High Efficiency LED Lighting
- Porcelain Foot Flush Toilet
- Mirrored Medicine Cabinet w/ Storage (VBF)
- Power Vent
- Skylight Shower/Tub Surround
- Designer Shower Curtain (VBF)

## Bedroom

- High Efficiency LED Lighting
- Foam Mattress
- Designer Valances

- 110V Outlet(s)
- Pleated Nightshades
- Designer Padded Headboard w/ Storage
- Quilted Reversible Comforter
- Overhead Storage
- Shirt Closet(s)
- USB Charger

## Exterior/Construction Standards

- High Efficiency LED Lighting
- One-Piece Seamless Fiberglass Roof
- Easy exchange 20# LP Tank
- Large Pass-Thru Storage
- Lighted Safety Step
- Norco-BAL E-Coated & Epoxy Painted Frame
- Five Sided Ivory Color Infused Fiberglass
- Tinted Safety Glass Windows
- Aluminum Framed Floor, Sidewalls and Roof
- (2) Marine Grade Speakers
- Large Bumper with Sewer Hose Storage
- Satellite & Cable Hookup

- Keyed-Alike Baggage & Entry Doors
- Double Entry Step
- Porch Light
- Water Heater Bypass Valve
- Tank Monitor System
- Marine Style 30 AMP Power Cord w/Light
- 6 Gallon DSI Gas/Electric Water Heater

## Exterior Luxury (Mandatory Option)

- High Polished Aluminum Rims
- (4) BAL Scissor Jacks w/Footpads
- Motorhome Lighted Grab Handle
- Black Tank Flush
- Prewire for Solar
- Prewire for Backup Camera
- Motorhome Style Slam Latch Baggage Doors w/Magnetic Catches
- Multi Directional LED Lighted Power Awning
- Exterior Shower w/Hot & Cold Water

## Interior Luxury Package (Mandatory Option)

- Bluetooth DVD/CD/MP3/AM/FM

- Stereo w/Remote
- 4.2 CU FT Refrigerator
- 2-Burner Cooktop
- Convection Microwave
- Vented Range Hood
- Residential 8,000 BTU A/C

## Options

- LED TV w/Swing Arm Bracket
- Low Profile 13.5 BTU A/C
- Lighted Power Tongue Jack
- Spare Tire, Carrier & Cover
- Swing Away Bumper Mount Grill
- A-Frame Bike Rack
- Cotton Cloud Mattress
- Observation Camera

## Boom Package – Option

- Aluminum Double Entry Steps
- Friction Hinge Entry Door
- Battery Disconnect Switch
- StorMor Bedside Night Stands
- Tufted Dinette Cushions
- Accented Stainless Steel Appliances
- Decorative Backsplash
- Power Tongue Jack

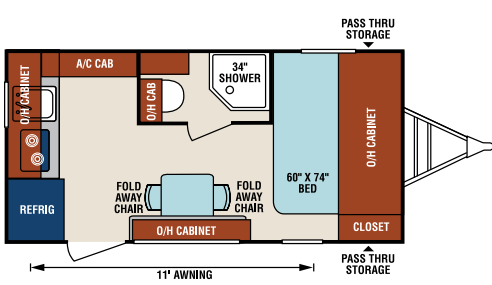

**SL149VML**

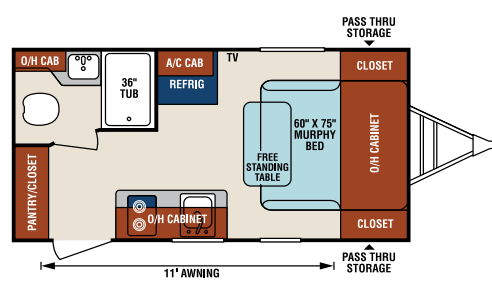

**SL150VRK**

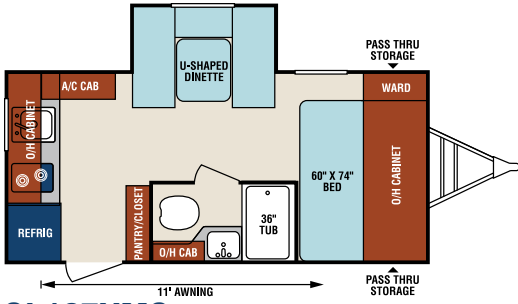

**SL167VMS**

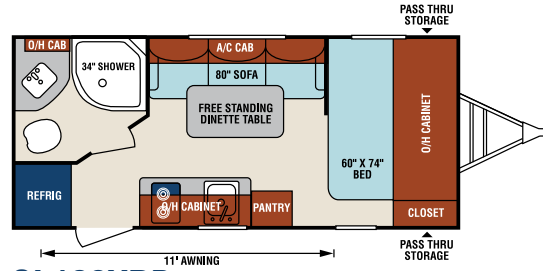

**SL168VRB**

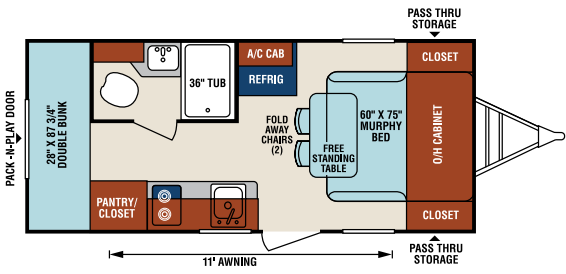

**SL169VBH**

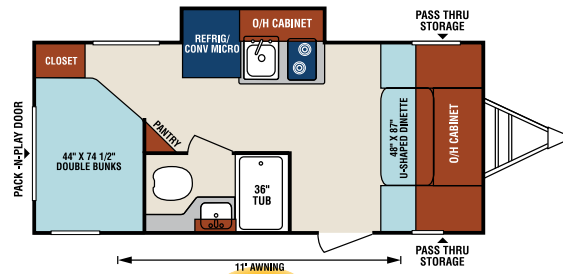

**SL169VDB** **NEW**

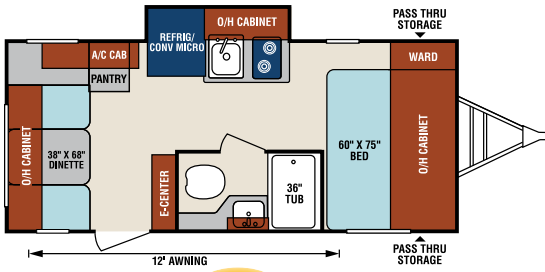

**SL169VRD** **NEW**

**Travel Trailers**

	SL149VML	SL150VRK	SL167VMS	SL168VRB	SL169VBH	SL169VDB	SL169VRD
UVW (Unloaded Vehicle Weight)*	2,745	2,480	2,898	2,950	2,990	3,318	3,376
Dry Hitch Weight*	290	270	350	300	410	369	332
Dry Axle Weight*	2,455	2,210	2,548	2,650	2,570	2,949	3,044
NCC (Net Carrying Capacity)	755	1,020	1,102	1,050	1,010	683	624
GVWR	3,500	3,500	4,000	4,000	4,000	4,000	4,000
Interior Height	82"	82"	82"	82"	82"	82"	82"
Exterior Height with A/C	9' 5"	9' 5"	9' 5"	9' 5"	9' 5"	9' 5"	9' 5"
Exterior Width	90"	90"	90"	90"	90"	90"	90"
Exterior Length	19' 2"	19' 2"	20' 4"	21'	21' 4"	21' 3"	21' 3"
Refrigerator (Cubic Feet)	4.2	4.2	4.2	4.2	4.2	4.2	4.2
Water Heater Capacity (Gal. G/E w/DSI)	6	6	6	6	6	6	6
Fresh Water Capacity (Gallon)	38	38	38	38	38	38	38
Black Water Capacity (Gallon)	30	30	30	30	30	26	30
Gray Water Capacity (Gallon)	41	30	41	30	30	30	30
LP Gas Capacity (Lbs.)	20	20	20	20	20	20	20
Furnace BTUs (1,000s)	16	16	16	16	16	16	16
Tire Size	14"	14"	15"	15"	15"	15"	15"
Awning	11'	11'	11'	11'	11'	11'	12'

\*This weight reflects the rolling average unit weight for each model. Your trailer weight will vary according to optional equipment.



985 N 900 W • Shipshewana, IN 46565  
[www.venture-rv.com](http://www.venture-rv.com)

Due to continual research and advances, manufacturer reserves the right to change specifications, design, price and equipment without notice, and assumes no responsibility for any error in this literature. Some items shown are not included as standard or optional equipment. ©2017 Venture | 9/5/17 | 15M