

STRATUS

ULTRA-Lite Travel Trailers



Available in Coco décor; Alpine White accented with Mountain Walnut.



Top Features:

1. Four High Gloss Exterior Colors (Victory Red, Indigo Blue, Aztec Grey & Polar White)
2. Sophisticated and Practical Interior Design with Alpine White & Mountain Walnut Wood Combination
3. Dry Weights Starting at 4,500 LB Up to 6,200 LB
4. All Floorplans Feature Pantries with Half Featuring Walk-In Pantries
5. 8 CU FT Refrigerator
6. 60" x 80" True Residential Queen Beds with Upgrade Mattress
7. Store-Mor Nightstands with 110 Outlet & USB Plugs (CPAP Sized)
8. Back Lit Dinette Booths
9. Entry Door Motion Light
10. Coat Hooks Located by Entry Door
11. Flip-Up Solid Step
12. Screen Shot Screen Door
13. (4) Ground Effect LED Lights
14. Doggie Dish Location
15. Venture Bottle Opener / Doggie Tie Down

Travel Trailers	SR231VRB	SR261VBH	SR261VRK	SR261VRL	SR271VRS	SR281VBH
UVW (Unloaded Vehicle Weight)*	5,240	TBD	5,850	5,860	5,890	6,270
Dry Hitch Weight*	560	TBD	590	590	610	670
Dry Axle Weight*	4,680	TBD	5,260	5,270	5,280	5,600
NCC (Net Carrying Capacity)	1,760	TBD	1,150	1,140	1,110	2,030
GVWR	7,000	7,000	7,000	7,000	7,000	8,300
Interior Height	82"	82"	82"	82"	82"	82"
Exterior Height with A/C	10' 10"	10' 10"	10' 10"	10' 10"	10' 10"	10' 10"
Exterior Width	96"	96"	96"	96"	96"	96"
Exterior Length	26' 9"	30' 3"	30' 3"	30' 3"	30' 7"	32' 1"
Refrigerator (Cubic Feet)	8	8	8	88	8	
Water Heater Cap. (Gal. Gas w/DSI)	6	6	6	66	6	
Fresh Water Capacity (Gallon)	40	40	40	40	40	40
Black Water Capacity (Gallon)	32	32	32	32	32	32
Gray Water Capacity (Gallon)	32	64	64	64	64	64
LP Gas Capacity (Lbs.)	(2) 20# Bottles	(2) 20# Bottles	(2) 20# Bottles	(2) 20# Bottles	(2) 20# Bottles	(2) 20# Bottles
Furnace BTUs (1,000s)	30	30	30	30	30	30
Tire Size	205/75R15D	205/75R15D	205/75R15D	205/75R15D	205/75R15D	225/75R15E
Awning	18'	18'	20'	16'	16'	20'

*This weight reflects the rolling average unit weight for each model. Your trailer weight will vary according to optional equipment.

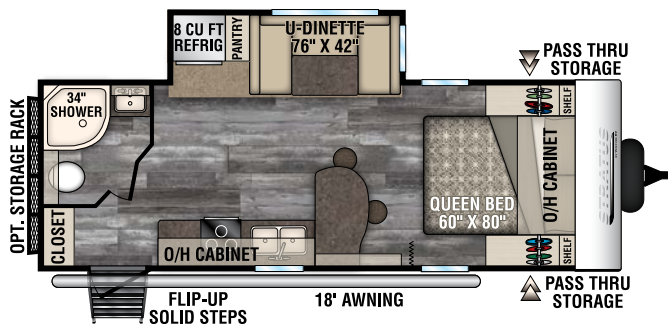

SR231VRB **NEW**

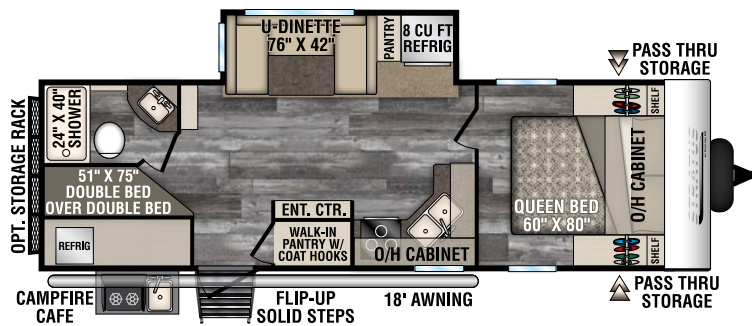

SR261VBH **NEW**

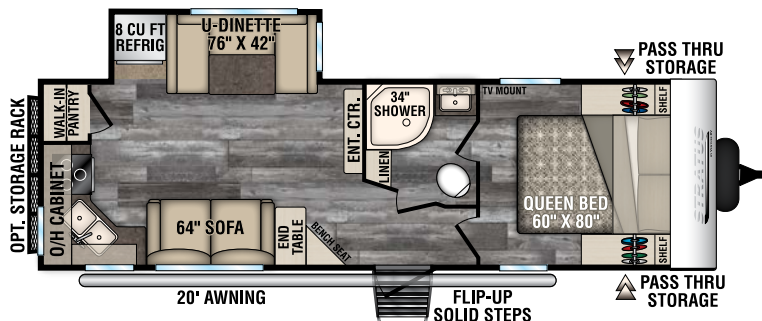

SR261VRK
Options

SR261VRK **NEW**

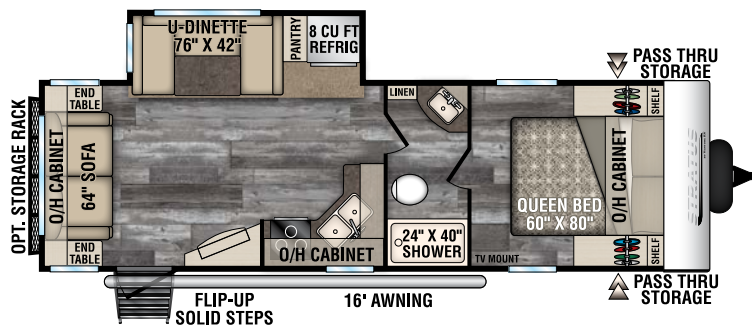
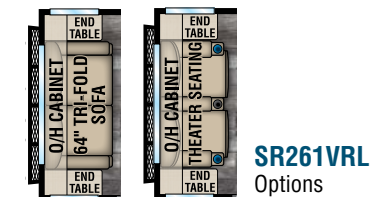

SR261VRL **NEW**

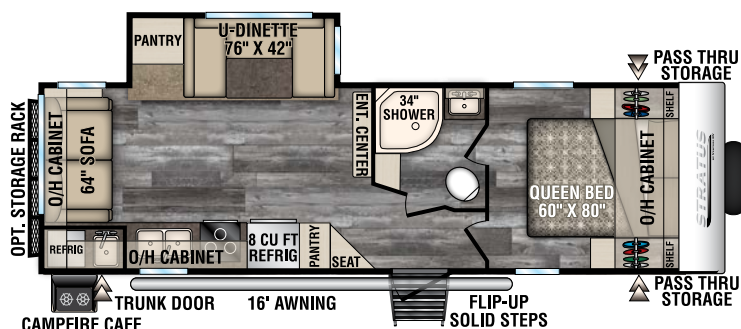
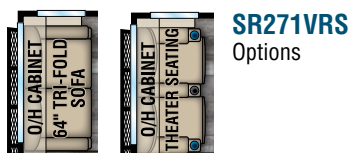

SR271VRS **NEW**

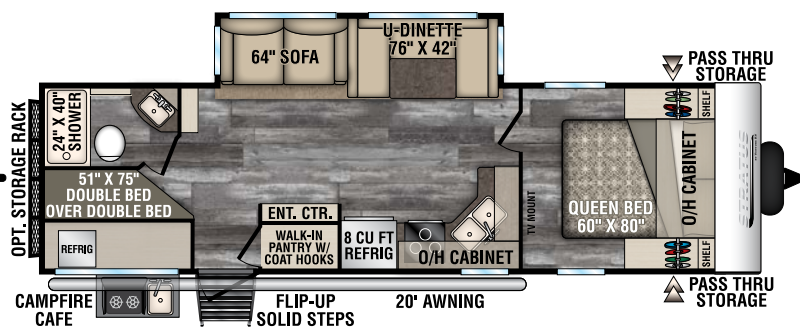

SR281VBH **NEW**



985 N 900 W • Shipshewana, IN 46565
www.venture-rv.com

Due to continual research and advances, manufacturer reserves the right to change specifications, design, price and equipment without notice, and assumes no responsibility for any error in this literature. Some items shown are not included as standard or optional equipment. ©2018 Venture | 12/10/18 | 25M