



# SONIC X

Travel Trailers



THE ULTIMATE RV!



*Designed for campers, by campers.*



The ultimate self-sustainable RV! Venture RV's Sonic X is like nothing you've ever experienced before, offering off-road, off-grid, off-the-charts adventure!

**KEY FEATURES:**

- Solar off-the-grid ready with (2) 250-amp hour lithium ION batteries
- Dexter Torsion axles
- 360-Degree welded tubular brush guard
- Two LED exterior light bars
- Extra-large fresh water tanks



Sonic X interiors include solid wood cabinets with roller ball bearing drawer guides, a large undermount stainless steel single bowl sink, and two interior speakers.



In the bed area, Sonic X offers a Murphy bed with foam mattress upgrade, StorMore nightstands with 110V and USB port, under-bed storage, and two shirt closets.

|                                    | SN211VDBX | SN220VRBX |
|------------------------------------|-----------|-----------|
| UVW (Unloaded Vehicle Weight)*     | 5,260     | 5,610     |
| Dry Hitch Weight*                  | 550       | 570       |
| Dry Axle Weight*                   | 4,710     | 5,040     |
| CCC (Cargo Carrying Capacity)      | 2,015     | 1,675     |
| Interior Height                    | 82"       | 82"       |
| Exterior Height with A/C           | 10' 4"    | 10' 4"    |
| Exterior Width                     | 90"       | 90"       |
| Exterior Length**                  | 27' 6"    | 27' 6"    |
| Refrigerator (Cubic Feet)          | 7         | 7         |
| Water Heater Cap. (Gal. G/E w/DSI) | 6         | 6         |
| Fresh Water Capacity (Gallon)      | 78        | 78        |
| Black Water Capacity (Gallon)      | 30        | 30        |
| Gray Water Capacity (Gallon)       | 30        | 30        |
| LP Gas Capacity (Lbs.)             | 40        | 40        |
| Furnace BTUs (1,000s)              | 20        | 20        |
| Tire Size                          | 15"       | 15"       |
| Awning                             | 14'       | 13'       |

**SN211VDBX**

UVW - 5,260 lbs.  
Ext. Length - 27' 6"  
Sleeps - 8

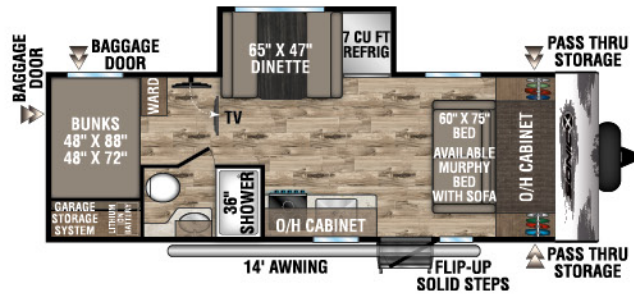

**SN220VRBX**

UVW - 5,610 lbs.  
Ext. Length - 27' 6"  
Sleeps - 4

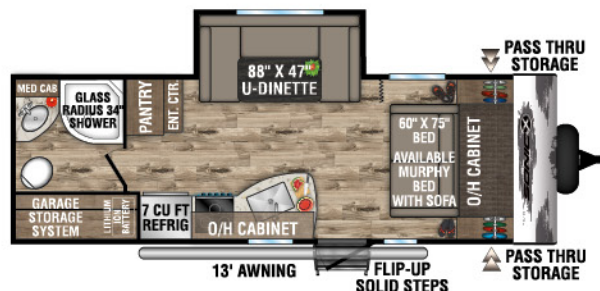

\*This weight reflects the rolling average unit weight for each model. Your trailer weight will vary according to optional equipment.  
\*\*Exterior length is measured from rear of bumper to leading edge of coupler.



# Extreme FEATURES

## Solar Package



**Camp anywhere at any time using energy-efficient and clean solar power. The GO Power Solar Package with a lithium ion battery, coupled with a low-consumption power air conditioner, allows for up to five hours of A/C without a recharge!\***

- ⊗ (2) 190 Watt Roof-Mounted Solar Panels
- ⊗ (2) 250 Amp Hour Lithium Ion Battery
- ⊗ (1) IC2000 Watt Inverter w/Charger
- ⊗ 11.5 BTU Low Profile/Low-Consumption Power A/C
- ⊗ High Definition Interior/Exterior LED Lighting

## Off Road Package



**Need to get away from it all? The Sonic X ultra-lite travel trailer is the RV for you. Explore the backcountry in confidence with our tough Off-Road Package!**

- ⊗ 360-Degree Welded Tubular Brush Guard
- ⊗ (2) Roof-Mounted High Definition LED Light Bars
- ⊗ Triple Stack Round Welded Bumper
- ⊗ (4) 15" Off-Road Tires
- ⊗ 15" Under-Mount Spare Tire
- ⊗ (2) 3,500 LB Torsion Axles
- ⊗ (4) High-Rise Power Stabilizer Jacks w/Independent Motors
- ⊗ 7 1/2" BAL Norco NXG Huck-Bolted Frame
- ⊗ 78 GAL Fresh Water Tanks



Front & rear LED light bars assist in loading & unloading

## Water Filtration System (Option)



**The Clearsource Nomad water filtration system will pull water from any source and purify it. Designed with the most outgoing campers in mind, this system will keep you hydrated, clean, and ready for your adventure. You'll have access to clean and safe water no matter where you go.**

- ⊗ Works with any 12-volt battery
- ⊗ 15 amp pump can draw water from a distance of up to 100' or 20' of elevation
- ⊗ Dual filters that remove harmful bacteria
- ⊗ Solid construction featuring a powder-coated chassis and heavy-duty electrical components
- ⊗ Safety protected on/off switch
- ⊗ Built-in attachment points for permanent mounting

## Storage System



**Do you enjoy land- or water-based outdoor adventures? Take them with you with Sonic X's Toy Storage System!**

- ⊗ Convertible Gear Rack
- ⊗ Hitch-Mounted Bike Rack
- ⊗ Outside Garage Storage System
- ⊗ Concealed Gun/  
Fishing Rod Cabinet



Built-in wall safe



Large hidden storage for fishing poles or hunting rifles



Front-mounted bike rack holds up to two bikes

*\*contingent on weather conditions*

# SONIC X PACKAGES & OPTIONS

## SONIC XTREME SOLAR PACKAGE (STANDARD)

(2) 190W roof mounted solar panels

(2) 250 amp hour lithium ION battery

IC2,000W inverter w/charger

11.5 low profile, low power consumption A/C

High definition interior/exterior LED lighting

## SONIC XTREME OFF-ROAD PACKAGE (STANDARD)

360-Degree welded tubular brush guard

(2) roof-mounted high definition LED light bars

Triple stack round welded bumper

(4) 15" off-road tires

15" under-mount spare tire

(2) 3,500 LB torsion axles

(4) high-rise power stabilizer jacks w/ independent motors

7 1/2" BAL Norco NXG Huck-bolted frame

78 GAL fresh water tank

## SONIC XTREME STORAGE SYSTEM (STANDARD)

Convertible gear/bike/cargo rack

Hitch-mounted bike rack

Outside garage storage system

Concealed gun/fishing rod cabinet

## WEATHER-SHIELD PACKAGE (STANDARD)

Forced-air heated & enclosed underbelly

360° residential fiberglass insulation

360° radiant foil insulation

Radiant foil bubble insulation-wrapped tanks

Lithium battery thermostat-controlled heat pad (360° = roof, floor, front/rear walls)

## SONIC XTREME LUXURY PACKAGE (STANDARD)

Solid-surface countertops

LED TV w/swing-arm mount

Dark-tint windows

## EXTERIOR PACKAGE (STANDARD)

Friction-hinge entry door

Battery disconnect switch

Steel fender guards,

3-piece fiberglass roof system

5/8" tongue & groove plywood floor decking

Spread axles w/auto-adjust brakes & EZ Lube hubs

NXG Huck-bolt frame

Prewired for Furrion backup camera

Dedicated cable & satellite hookups

Furrion marine-grade detachable power cord

Slam-latch baggage doors w/ magnetic catches

Motion-activated pass-thru storage light

Hot & cold outside shower

Keyed Alike key system

Venture bottle opener/dog tie-out

Carbon fiber pattern rock guard & slideout end walls

Solid flip-up step

Swing-away grab handle

Screen Shot spring screen door

LED lighted power awning

Black tank flush

(2) 20 LB LP tanks w/easy-access cover

## INTERIOR PACKAGE (STANDARD)

Bathroom power exhaust fan

Porcelain foot-flush toilet

StorMore bedside nightstands w/110V & USB charging

Quilted comforter

Designer padded headboard

6 GAL gas/electric DSI water heater

Safe "T"ek Box w/110V & USB charging ports

Motion-activated interior entry light

Beauflor residential linoleum w/7-year limited warranty

Living area skylight

LED lighting w/individual switches

82" ceiling height

Shoe cubby (VBF)

Stainless steel microwave

Designer tile backsplash

7 CU FT double-door refrigerator/freezer

Vented range hood

Surf(x) seamless tabletops

Euro steel faucet

## OPTIONS

Nomad Xtreme water filtration system

12V 8 CU FT refrigerator



985 N 900 W | Shipshewana, IN 46565 | [www.venture-rv.com](http://www.venture-rv.com)

Due to continual research and advances, manufacturer reserves the right to change specifications, design, price, and equipment without notice, and assumes no responsibility for any error in this literature.

Some items shown are not included as standard or optional equipment.

©2022 Venture | 00/00/22 | 00M